

Radio control model

R/C Flugmodell

INSTRUCTION MANUAL MONTAGEANLEITUNG

DORNIER DO-27

Designed for brushless electric motors (.46-.52 class glow conversion optional)

Entwickelt für Brushless Elektro Motoren (7,5 -8,5cc Glühzündermotor Einbau möglich)



VQ No: VQA090

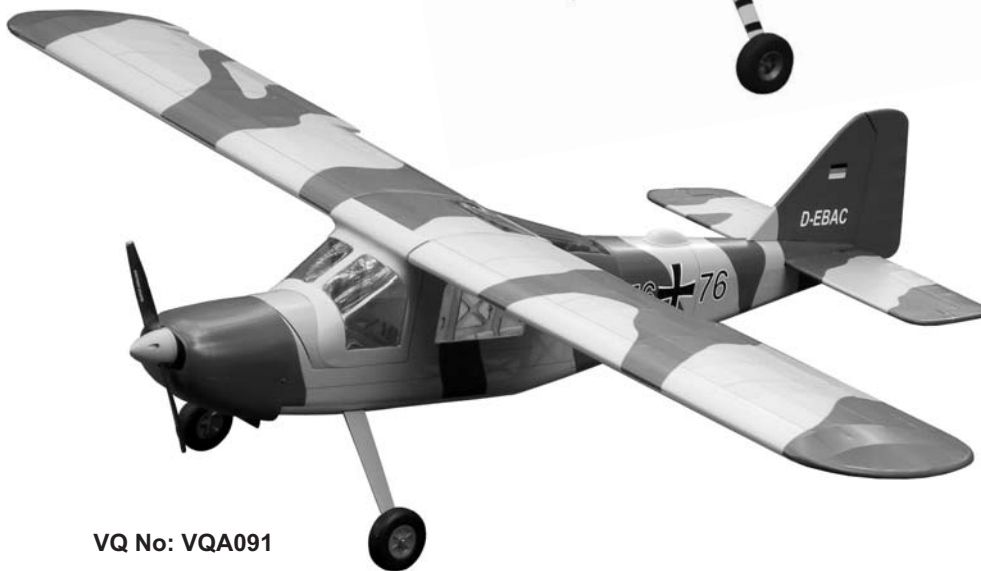

VQ No: VQA091



TECHNISCHE DATEN

Spannweite	1620mm
Länge	1210mm
Elektroantrieb	(siehe nächste Seite)
Verbrennerantrieb	7.5cc 2-T / 8.5cc 4-T
Fernsteuerung	6 Kanal / 6-7 Servos

SPECIFICATIONS

Wingspan	63 in.
Length	47.6 in.
Electric Motor	(See next page)
Glow Engine	.46 2Stroke / .52 4-Stroke
Radio	6 Channel / 6-7 Servos

WARNING! This radio controlled model is NOT a toy. If modified or flown carelessly it could go out of control and cause serious human injury or property damage. Before flying your airplane, ensure the air field is spacious enough. Always fly it outdoors in safe areas and seek professional advice if you are unexperienced.

ACHTUNG! Dieses ferngesteuerte Modell ist KEIN Spielzeug! Es ist für fortgeschrittene Modellflugpiloten bestimmt, die ausreichende Erfahrung im Umgang mit derartigen Modellen besitzen. Bei unsachgemäßer Verwendung kann hoher Personen- und/oder Sachschaden entstehen. Fragen Sie in einem Modellbauverein in Ihrer Nähe um professionelle Unterstützung, wenn Sie Hilfe im Bau und Betrieb benötigen. Der Zusammenbau dieses Modells ist durch die vielen Abbildungen selbsterklärend und ist für fortgeschrittene, erfahrene Modellbauer bestimmt.

RECOMMENDED ACCESSORIES (Purchase separately) Empfohlenes Zubehör (Nicht im Lieferumfang enthalten)

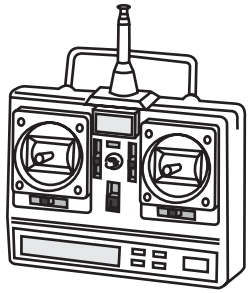

6 - channel radio
6 - Kanal
Fernsteuerung



Antrieb Standard:

BOOST 40 Brushless Combo Set, Best.Nr. C2983
LiPo Battery RED POWER 3200-3S, Best.Nr. C3164
Luftschraube 12*6, Best.Nr. C1937

Antrieb Tuning (Kraftvoller Kunstflug):

BOOST 60 Brushless Combo Set, Best.Nr. C3174
LiPO Akku RED POWER 4250-5S, Best.Nr. C4547
Luftschraube 13*8, Best.Nr. C2846

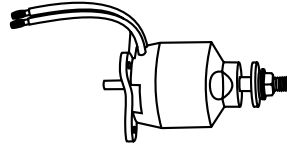

Egänzungskit Verbrenner
(Tank + Motorträger)
Best.Nr. C4165

1 x Servo S4020
(für Seitenruder)
Best.Nr. C1687

3 x Servo S4020
(für Höhen- und Querruder)
Best.Nr. C4995

2 X Servo DS3012
(Für Landeklappen)
C4995

Cyanoacrylate Glue
Sekundenkleber



Silicon Glue
Silikonkleber



Epoxy Glue (30 minutes type)
Epoxy-Klebstoff (30min)

Tool Required/ Empfohlenes Werkzeug

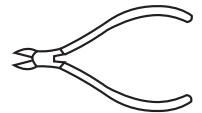
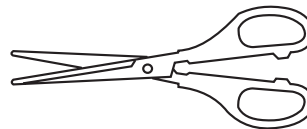
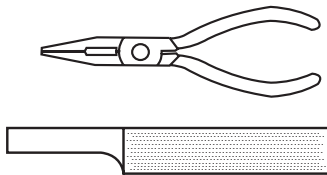



The pre-covered film on ARF kit may wrinkle due to variations of temperature.
Store model in a cool and dry place for awhile.
Then, starting with low heat, you may carefully use a hair dryer to smooth out wrinkles.

Die Bespannung des Modells kann durch Temperatureinflüsse erschlaffen oder Falten werfen z.b bei zu starker Sonneneinstrahlung oder Hitze.
Stellen Sie das Modell zunächst an einen kühlen Platz für eine bestimmte Zeit. Danach können Sie versuchen die restlichen Falten vorstichtig mit einem Haartrockner zu behandeln.





 Drill holes using the stated size of drill (in this case 1.5 mm Ø)

 Take particular care here

 Hatched-in areas: remove covering film carefully

 Check during assembly that these parts move freely, without binding

 Use epoxy glue

 Apply cyano glue

 Assemble left and right sides the same way.

 Not included. These parts must be purchased separately

 Löcher bohren mit dem angegebenen Bohrer (hier 1,5 mm)

 Hier besonders aufpassen

 Schraffierte Stellen, Bespannfolie vorsichtig entfernen

 Während des Zusammenbaus immer prüfen, ob sich die Teile auch reibungslos bewegen lassen

 Epoxy-Klebstoff verwenden

 Sekundenkleber auftragen

 Linke und rechte Seite wird gleichermaßen zusammgebaut

 Nicht enthalten. Teile müssen separat gekauft werden.

CONVERSION TABLE

1.0mm = 3/64"	3.0mm = 1/8"	10mm = 13/32"	25mm = 1"
1.5mm = 1/16"	4.0mm = 5/32"	12mm = 15/32"	30mm = 1-3/16"
2.0mm = 5/64"	5.0mm = 13/64"	15mm = 19/32"	45mm = 1-51/64"
2.5mm = 3/32"	6.0mm = 15/64"	20mm = 51/64"	

1

1A

Full the elevator out of the horizontal stabilizer.

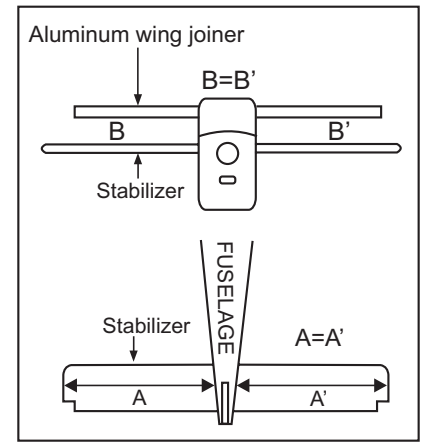
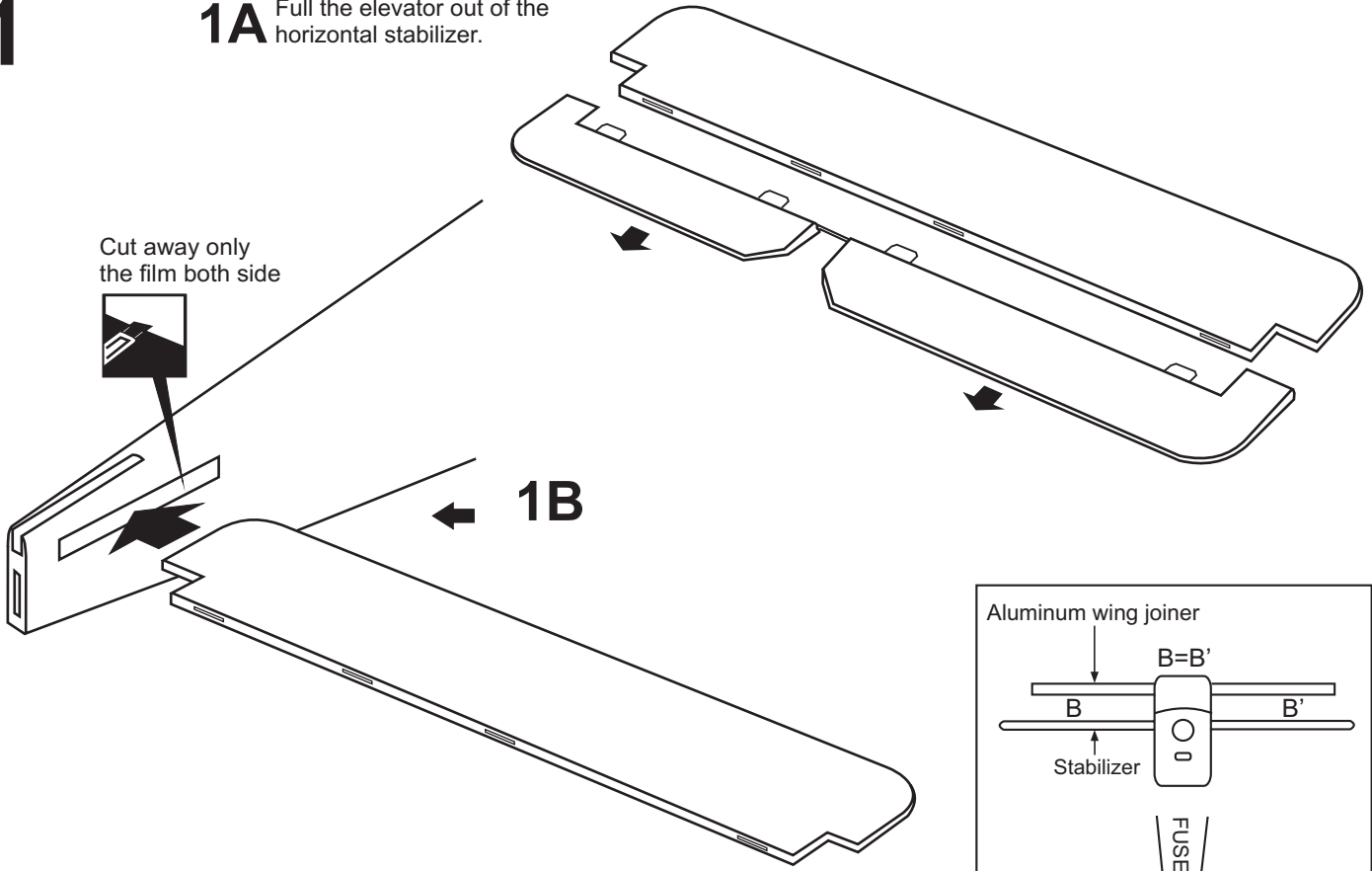

1C

When you are satisfied with the alignment, use a pencil to trace around the top and bottom of the stabilizer where it meets the fuselage.

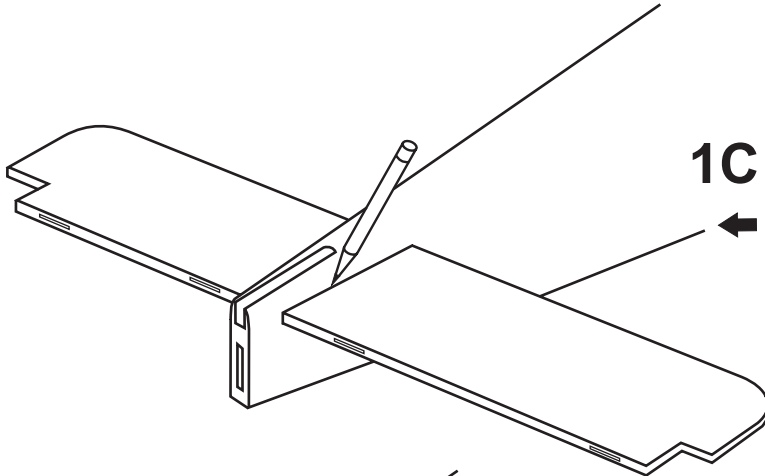

1D

Remove the horizontal stabilizer from the fuselage. Using the sharp hobby knife, carefully cut away the covering inside the lines which were marked above.

*** WARNING: When removing any covering from the airframe, please ensure that you secure the cut edge with CA or similar cement. This will ensure the covering remain tight.**

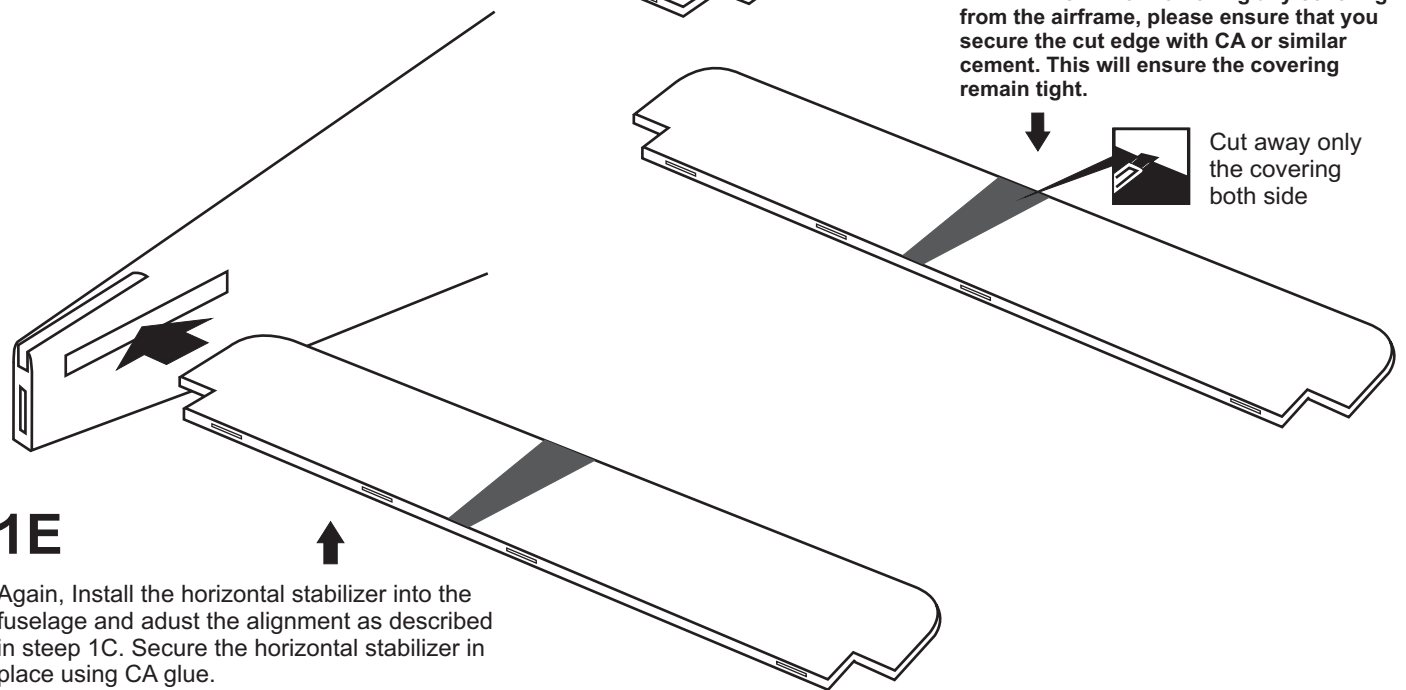

1E

Again, Install the horizontal stabilizer into the fuselage and adjust the alignment as described in step 1C. Secure the horizontal stabilizer in place using CA glue.

1F

Thin CA glue

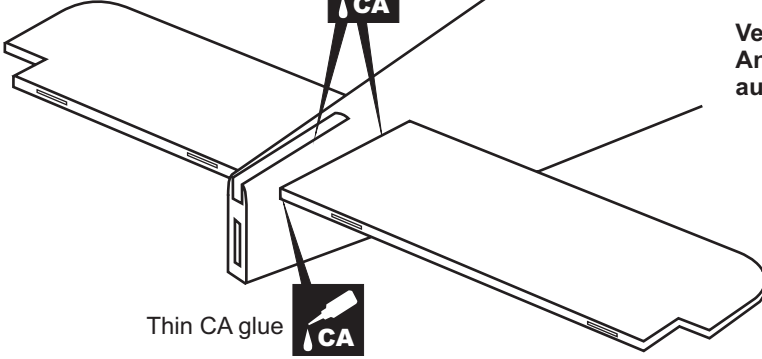

Thin CA glue



WARNING! Securely glue together. If coming off during flights, you lose control of your airplane which leads to accidents !

Vergewissern Sie sich, sauber geklebt zu haben. Andernfalls können Probleme mit der Flugeigenschaft auftreten!

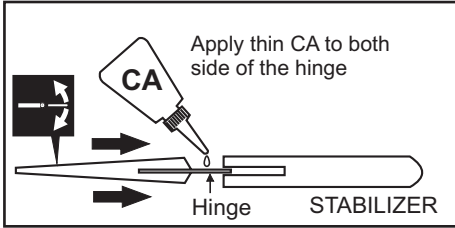

Apply thin CA to both side of the hinge

Hinge STABILIZER

1G

Elevator connector

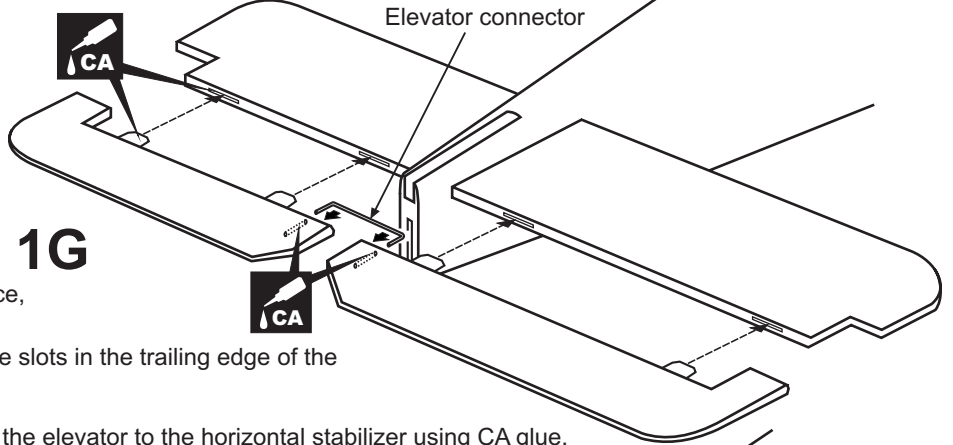

First, reposition the elevator connector in place, secure it in place using thin CA glue.

Push the elevator and its hinges into the hinge slots in the trailing edge of the horizontal stabilizer.

There should be a minimal hinge gap.

When satisfied with the and alignment, hinge the elevator to the horizontal stabilizer using CA glue.

1H

Note: The slots for the control horn installation are pre-cut at factory.

Control horn

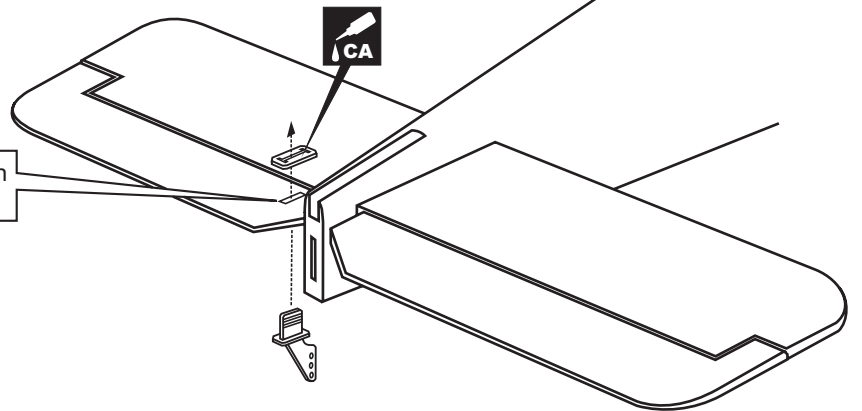
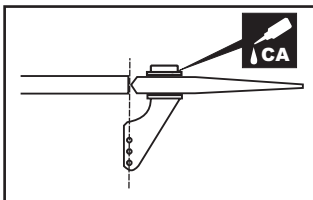
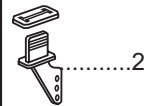

2

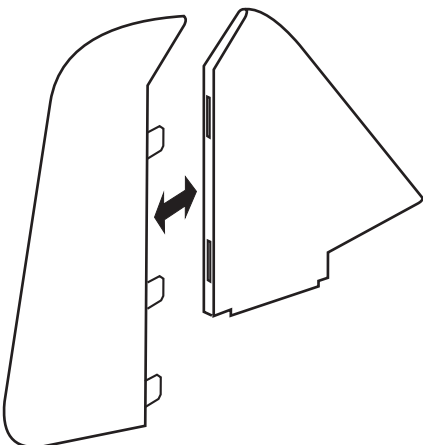

2A Full the rudder out of the vertical stabilizer.

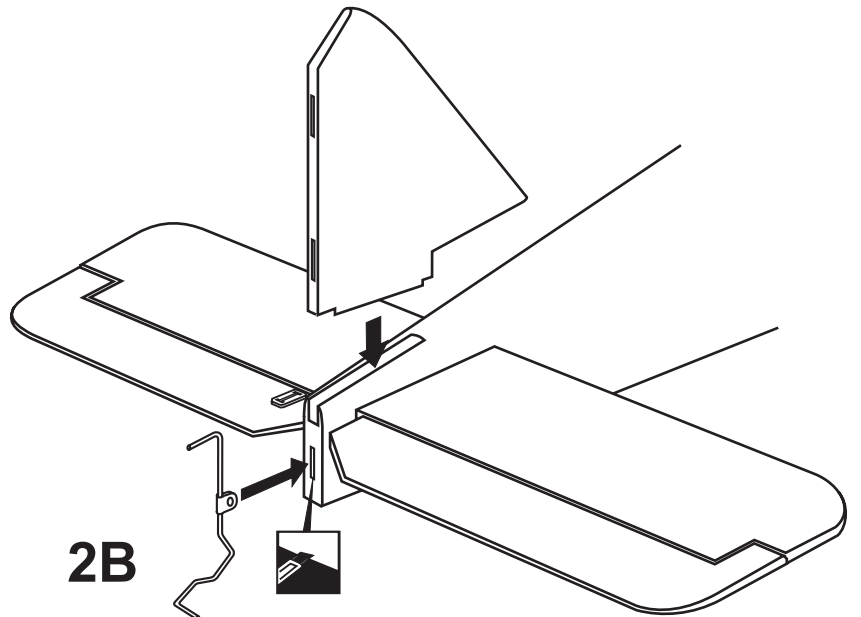

2B



2C

When you are satisfied with the alignment, use a pencil to trace around the right and left of the stabilizer where it meets the fuselage.

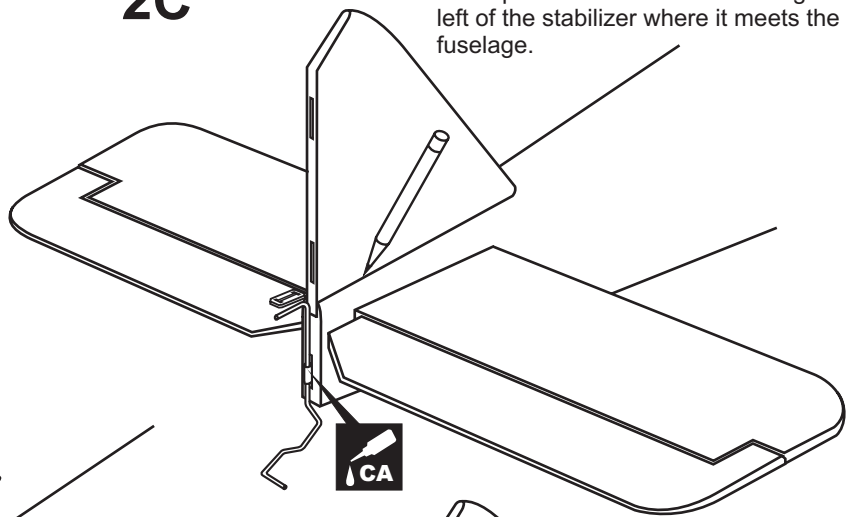

2D

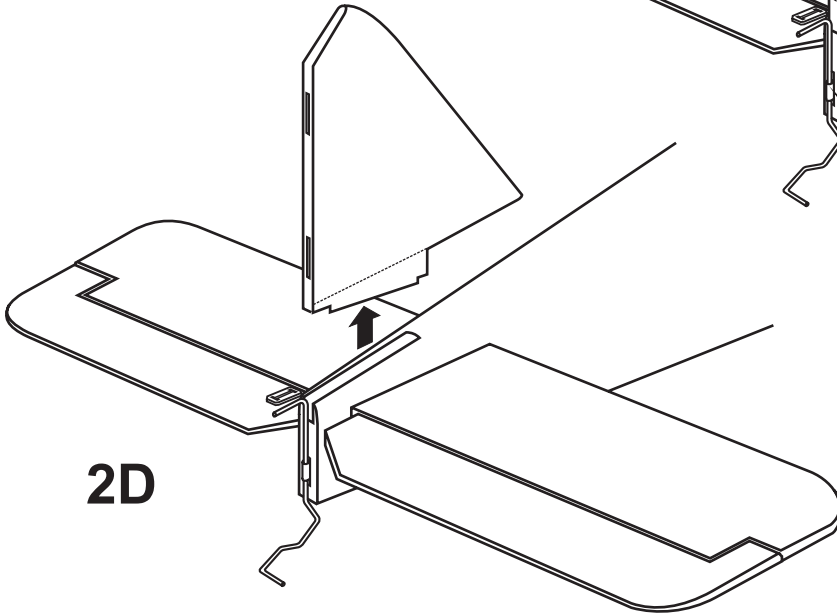

2E

Cut away only the covering both side

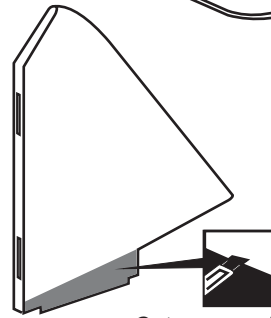

WARNING! Securely glue together. If coming off during flights, you lose control of your airplane which leads to accidents !

Vergewissern Sie sich, sauber geklebt zu haben. Andernfalls können Probleme mit der Flugeigenschaft auftreten!

2F

Realign the vertical stabilizer, then glue the vertical stabilizer into the fuselage, using a generous amount of thin CA.

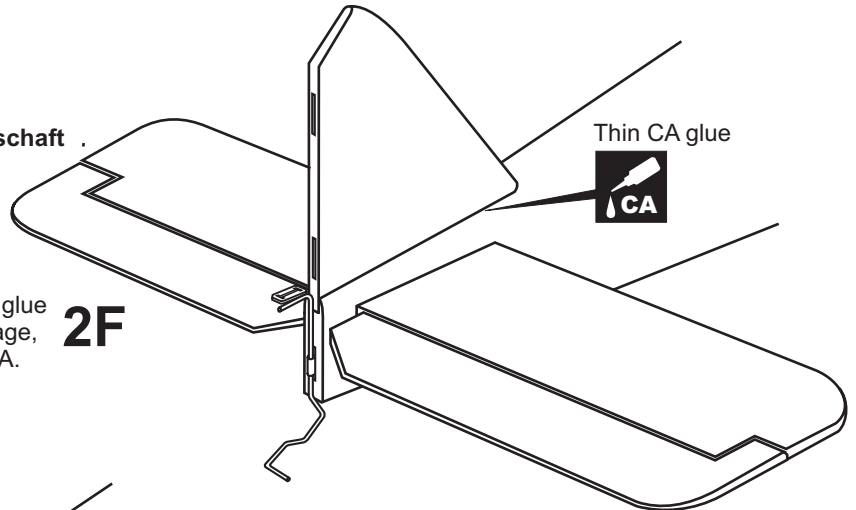

Thin CA glue



2H



25mm tail wheel
2mm collar

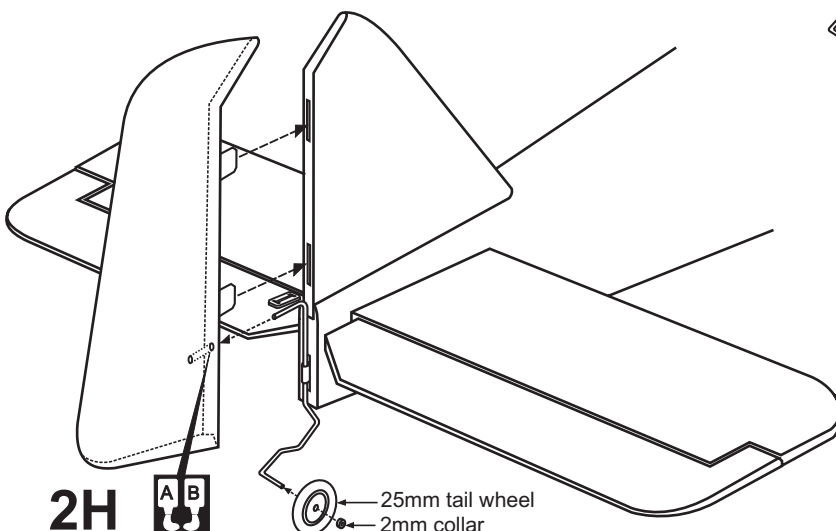

A=38mm

2G

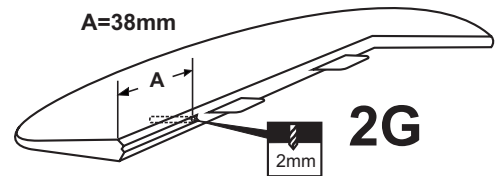

Drill a 2mm diameter hole in torque rod mounting slot, marking sure that you drill the hole perpendicular to the leading edge of the rudder.

Apply thin CA to both side of the hinge

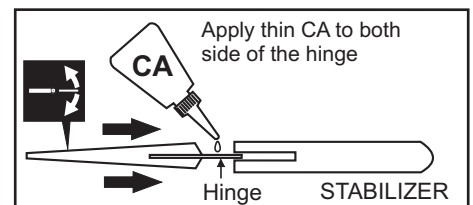

Push the rudder and its hinges into the hinge slots in the trailing edge of the horizontal stabilizer. There should be a minimal hinge gap.

When satisfied with the and alignment, hinge the elevator to the horizontal stabilizer using CA glue.

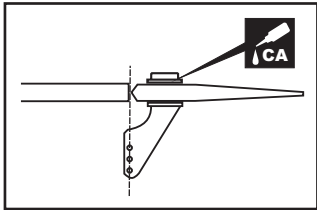

Note: The slots for the control horn installation pre-cut at factory.

2G

Control horn

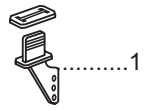

WARNING! Securely glue together.
If coming off during flights, you lose control
of your airplane which leads to accidents !

**Vergewissern Sie sich, sauber geklebt zu haben.
Andernfalls können Probleme mit der Flugeigenschaft auftreten!**

3

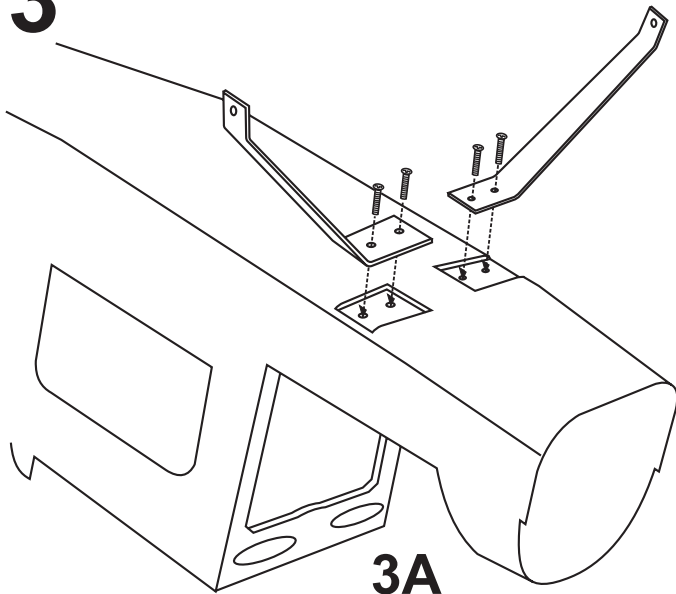

3A

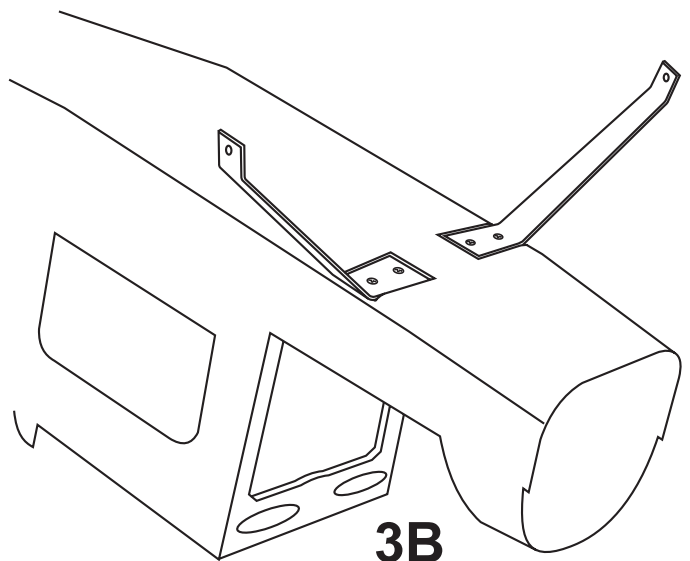

3B

4X20mm screw



4X30mm screw



4mm nut-washer



4mm washer

4mm nut

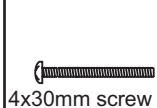

4x30mm screw

Aluminum landing gear

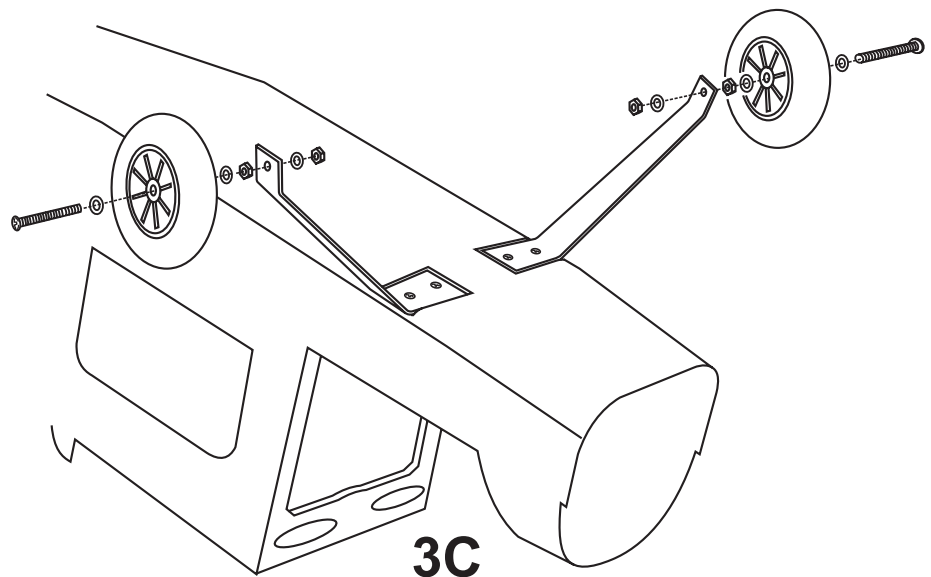

3C

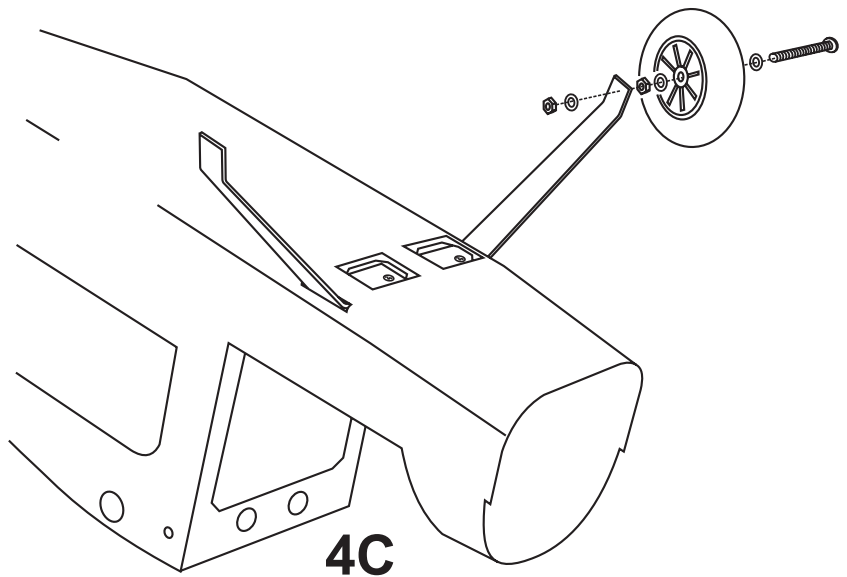

4C

5

5A

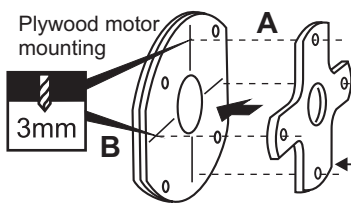

Using an aluminum motor mounting plate as a template, mark the plywood motor mounting plate where the four holes are to be drilled (A). Remove the aluminum motor mounting plate and drill a 3mm hole through the plywood at each of the four marks marked (B).

← Aluminum motor mounting plate (included with electric motor set)

5B

Pull the magnetic battery hatch out of the fuselage

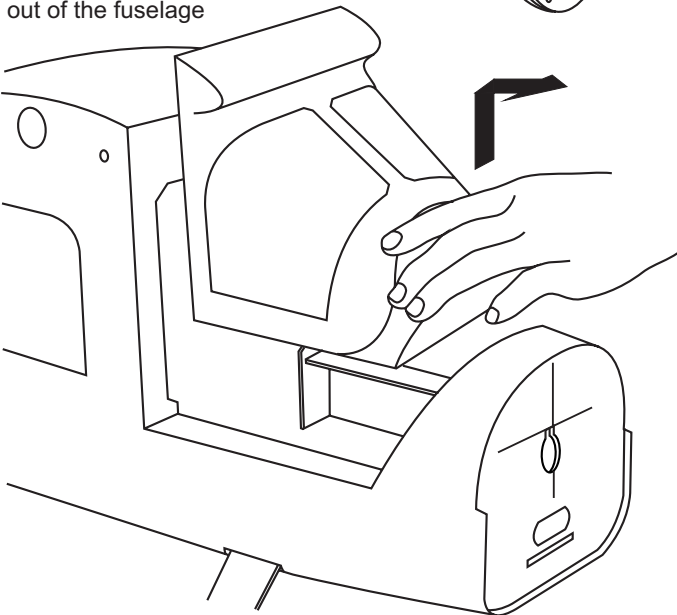

Using a plywood motor mounting plate as a template, mark the fire-wall where the four holes are to be drilled (C).

5C

! Align the mark on plywood motor mounting with the center mark on the fire-wall

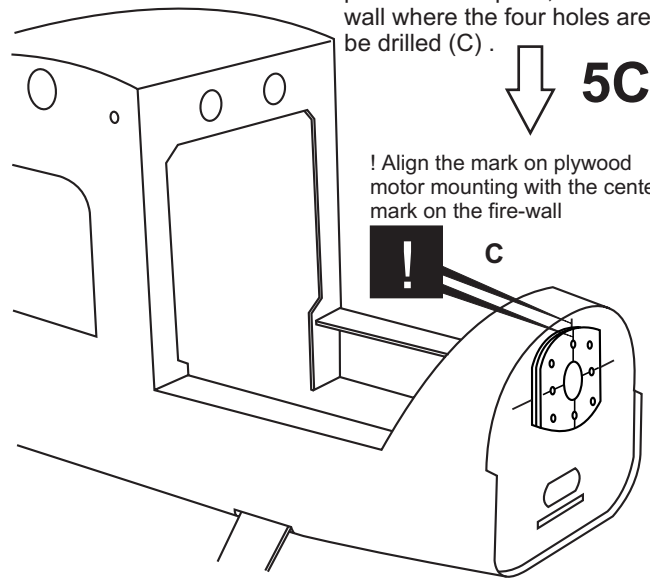

Remove the plywood motor mounting plate and drill a 5mm hole through the fire-wall at each of the four marks marked above (D).

5D

13/64" 5mm

13/64" 5mm

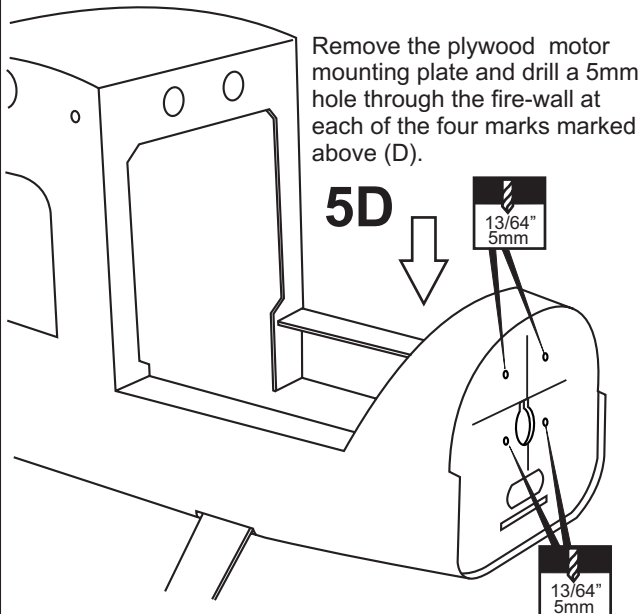

Push the four 5x35mm bolts through the fire-wall as shown (E)

Reposition the plywood motor mounting plate and secure it in place with twelve 5mm nuts and washers (E).

5E

E

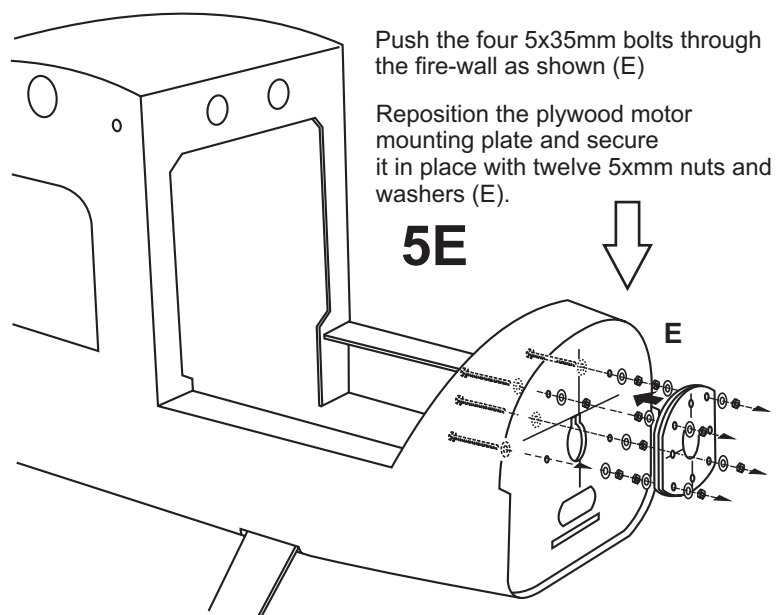

5F

Attach the aluminum motor mounting plate on to the motor and secure it in place with four screws (included with motor set) (F).

SIDE-VIEW / Seitenansicht

$B=B'$

Firewall

113mm

TOP-VIEW / Draufsicht

$A=A'$

! Engine thrust on balk head is already adjust at factory
Sturz und Zug beachten!

Sperrholztrager Platten zusammenkleben, wie gezeigt ausrichten und Locher bohren.
Motor nach untenstehendem Schema einbauen.
 Fur optimale Leistung empfehlen wir folgende Komponenten:
 -Brushless-Motor PICHLER BOOST 60
 -Brushless Regler PICHLER XQ-70
 -LiPO Akku LEMONRC 3700-5S
 -Luftschraube 12*6 - 13*8

For maximum performance, we recommended the following:
 -Brushless-Motor PICHLER BOOST 60
 -Brushless Regler PICHLER XQ-70
 -LiPO Battery LEMONRC 3700-5S
 -Propeller 12*6 - 13*8

6

FRONT

X Tipp
 Battery seat bell
 Akku Klettband aus dem PICHLER Sortiment
 Best.Nr. C4739

6A

Elevator servo

Elevator pushrod

Throttle servo

Throttle pushrod

BOARD - TOP VIEW

6B

6C

Rudder servo (mini servo)

FUSELAGE - BOTTOM VIEW

The holes for the rudder servo are Pre-cut at factory (left and right side of the fuselage).
Cut away only the covering

10

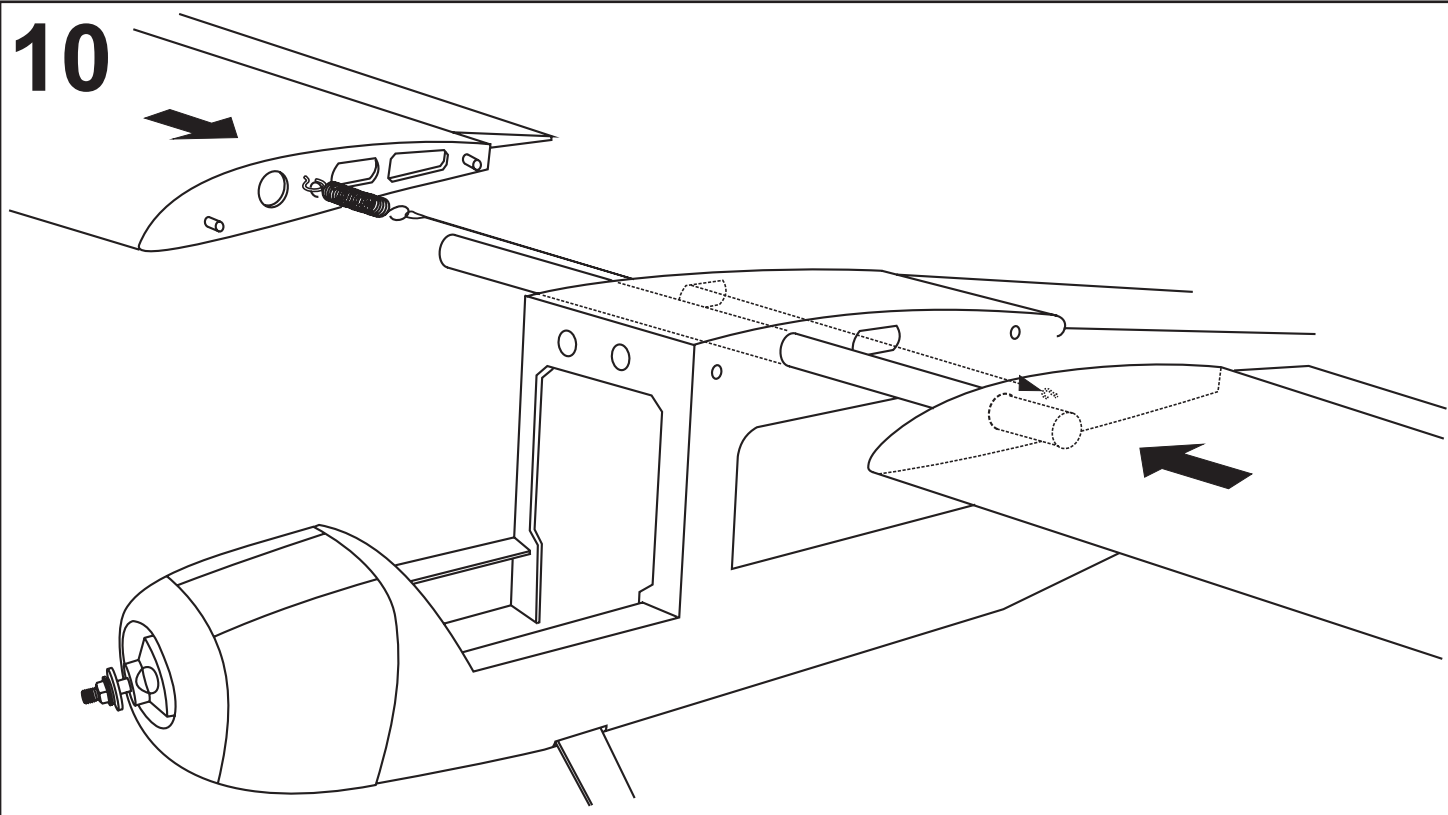

11

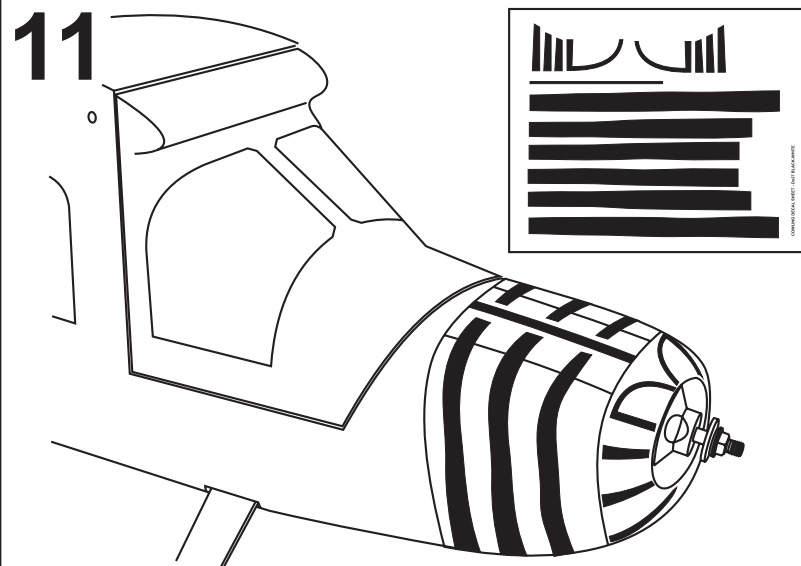

Note: Cut out the stickers and apply them in the proper area. Do not peel the backing paper off all at once. Peel off one corner of the backing and cut off with scissors. Arrange sticker on model and when satisfied adhere the corner without backing. Carefully peel back the rest of the backing while at the same time adhering the rest of the sticker.

Try not to make air bubbles, if there are some, carefully puncture sticker (center of bubble) but not model surface with the tip of the knife or sharp pin and squeeze out the air. At curves stretch sticker and apply a little heat so that no creases occur. Cut off the excess that is produced.

12

Überprüfen Sie vor dem Flug den Schwerpunkt.

Do not try to fly an out-of balance model!

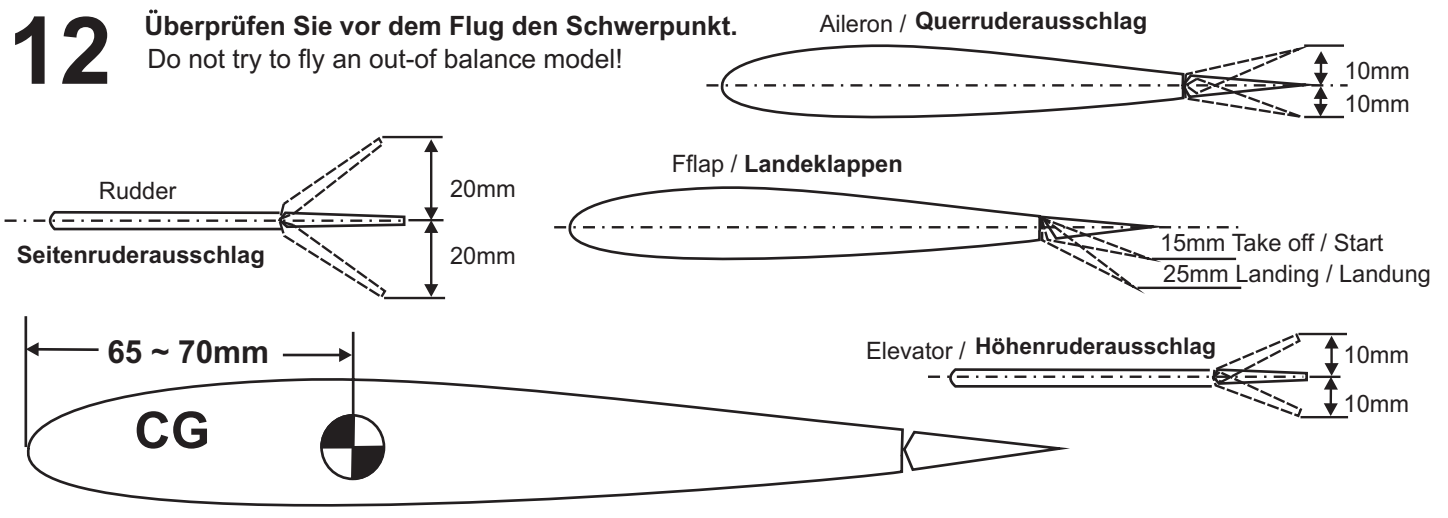

IMPORTANT: Please do not clean your model with pure alcohol, only use liquid soap with water or use glass cleaner to clean on surface of your model to keep the colour not fade.

All details are subject to change without notice !

Technische Änderungen und Irrtümer vorbehalten !

RECOMMENDED ACCESSORIES (Purchase separately)

Empfohlenes Zubehör (Nicht im Lieferumfang enthalten)

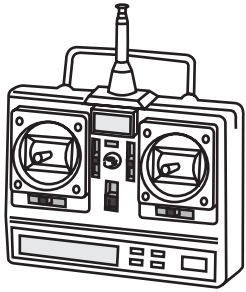

6 - channel radio
6 - Kanal
Fernsteuerung



Antrieb Standard:

BOOST 40 Brushless Combo Set, Best.Nr. C2983
LiPo Battery RED POWER 3200-3S, Best.Nr. C3164
Luftschraube 12*6, Best.Nr. C1937

Antrieb Tuning (Kraftvoller Kunstflug):

BOOST 60 Brushless Combo Set, Best.Nr. C3174
LiPO Akku RED POWER 4250-5S, Best.Nr. C4547
Luftschraube 13*8, Best.Nr. C2846

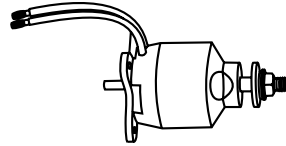

Egänzungskit Verbrenner
(Tank + Motorträger)
Best.Nr. C4165

1 x Servo S4020
(für Seitenruder)
Best.Nr. C1687

3 x Servo S4020
(für Höhen- und Querruder)
Best.Nr. C4995

2 X Servo DS3012
(Für Landeklappen)
C4995



Cyanoacrylate Glue
Sekundenkleber



Silicon Glue
Silikonkleber



Epoxy Glue (30 minutes type)
Epoxy-Klebstoff (30min)

Tool Required/ Empfohlenes Werkzeug

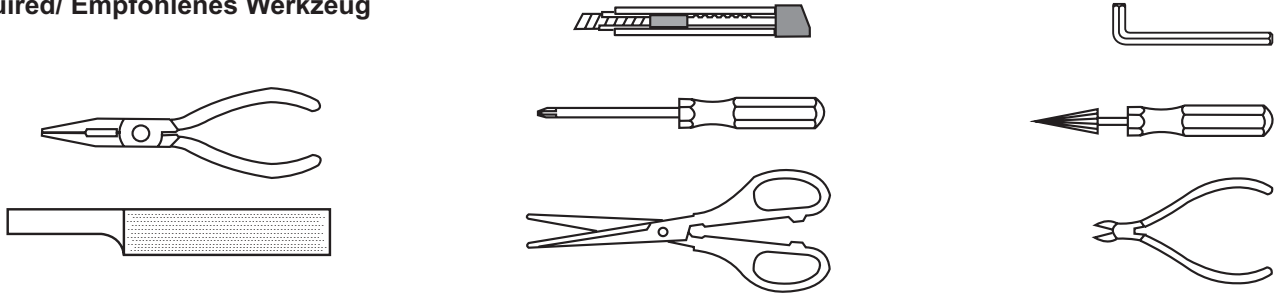

The pre-covered film on ARF kit may wrinkle due to variations of temperature.
Store model in a cool and dry place for awhile.
Then, starting with low heat, you may carefully use a hair dryer to smooth out wrinkles.

Die Bespannung des Modells kann durch Temperatureinflüsse erschlaffen oder Falten werfen z.b bei zu starker Sonneneinstrahlung oder Hitze.
Stellen Sie das Modell zunächst an einen kühlen Platz für eine bestimmte Zeit. Danach können Sie versuchen die restlichen Falten vorstichtig mit einem Haartrockner zu behandeln.





 Drill holes using the stated size of drill (in this case 1.5 mm Ø)

 Take particular care here

 Hatched-in areas: remove covering film carefully

 Check during assembly that these parts move freely, without binding

 Use epoxy glue

 Apply cyano glue

 Assemble left and right sides the same way.

 Not included. These parts must be purchased separately

 Löcher bohren mit dem angegebenen Bohrer (hier 1,5 mm)

 Hier besonders aufpassen

 Schraffierte Stellen, Bespannfolie vorsichtig entfernen

 Während des Zusammenbaus immer prüfen, ob sich die Teile auch reibungslos bewegen lassen

 Epoxy-Klebstoff verwenden

 Sekundenkleber auftragen

 Linke und rechte Seite wird gleichermaßen zusammgebaut

 Nicht enthalten. Teile müssen separat gekauft werden.

CONVERSION TABLE

1.0mm = 3/64"	3.0mm = 1/8"	10mm = 13/32"	25mm = 1"
1.5mm = 1/16"	4.0mm = 5/32"	12mm = 15/32"	30mm = 1-3/16"
2.0mm = 5/64"	5.0mm = 13/64"	15mm = 19/32"	45mm = 1-51/64"
2.5mm = 3/32"	6.0mm = 15/64"	20mm = 51/64"	